

## 5.4 Replacement Parts - CER-16 and 20

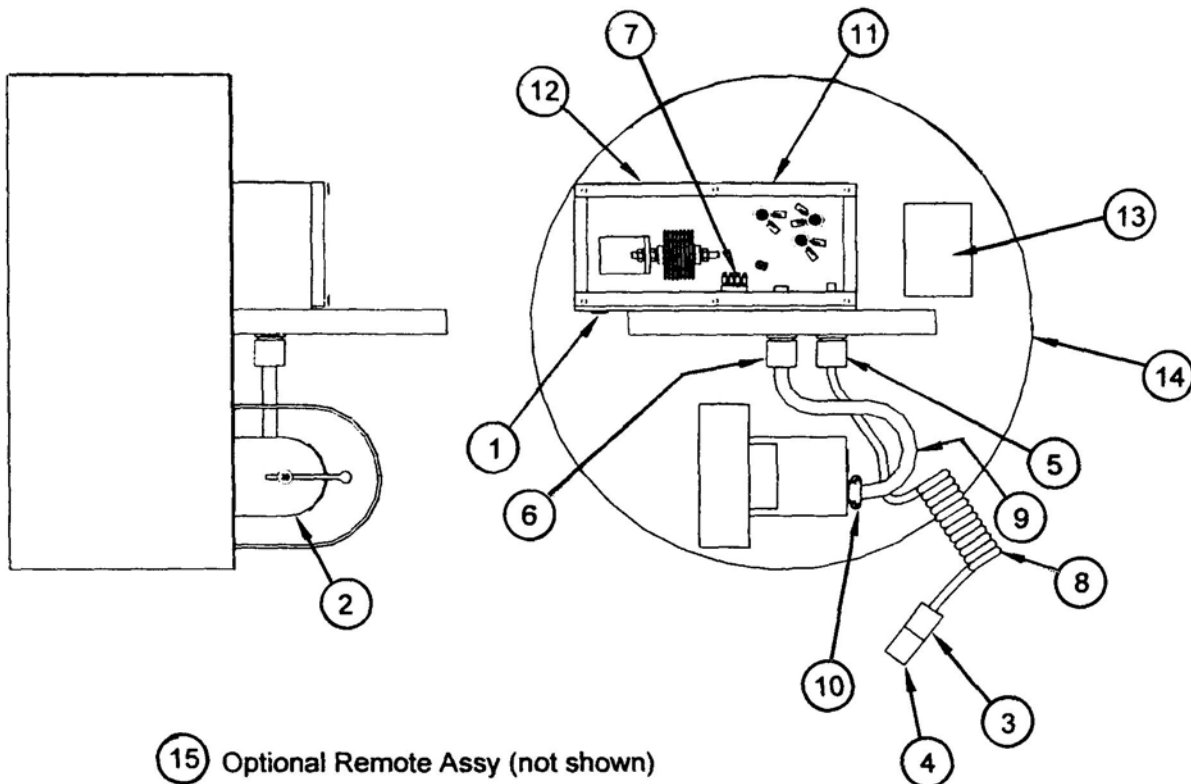

**WARNING: IMPROPER WIRING CAN RESULT IN REDUCED HOLDING POWER**

**Table 5-4 CER-16 & 20 Replacement Parts List**

ITEM NO.	PART DESCRIPTION	PART NO.
1	INDICATOR (PILOT LIGHT)	18-2001
2	DRUM SWITCH	54-BXM3638
3	PLUG, TWIST LOCK	11--2001
4	RECEPTACLE, TWIST LOCK	11-2010
5	CORD STRAIN RELIEF, AC	17-0014
6	CORD STRAIN RELIEF, SWITCH	17-0027
7	RECTIFIER ASSY	54-DD11298A
8	AC CORD ASSY	54-DD14857
9	SWITCH CORD ASSY	54-DD14858
10	CABLE CLAMP	14-1415
11	OPERATING INSTRUCTIONS	37-DD12082
12	LIFTING GUIDELINES	37-DD12088
13	DANGER TAG	37-DD11001
14	DANGER TAG	37-DD10963
15	REMOTE ASSY	54-BB7866-1
16	SUPPRESSOR REPAIR KIT CER-16	54-DD14926
17	RESISTOR REPAIR KIT (7.5 OHM) CER-16	54-DD14927
18	RESISTOR REPAIR KIT (15 OHM) CER-16	54-DD14928
19	SUPPRESSOR REPAIR KIT CER-20	54-DD14904
20	RESISTOR REPAIR KIT (10 OHM) CER-20	54-DD14905
21	RESISTOR REPAIR KIT (5 OHM) CER-20	54-DD14906
22	RIGID EPOXY PATCH KIT	06-DD14974